

X	Y
73,5	BR. Ø 7,65 x Z=20 BR. Ø 8 x Z=24
82	BR. Ø 7,65 x Z=20 BR. Ø 8 x Z=24
95	BR. Ø 7,65 x Z=20 BR. Ø 8 x Z=24
110	BR. Ø 7,65 x Z=20 BR. Ø 8 x Z=24

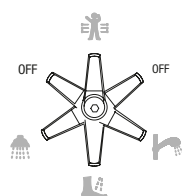

### Art. 5710R

Versione ceramica 1 entrata + 4 uscite + OFF

Ceramic version 1 entry + 4 exits + OFF

Keramikausführung 1 Eingang + 4 Ausgänge + OFF

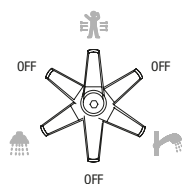

### Art. 5710R/3OFF

con 3 OFF

with 3 OFF

mit 3 OFF

## Accessori - Accessories - Zubehörteile

### Art. 0120

Maniglia deviatore  
Diverter handle  
Umstellgriff



Adattatore  
Ring adaptor  
Adapter

Art. 2501 A Ø 26X19"  
Art. 2502 A Ø 27X19"  
Art. 2504 A G.3/4"

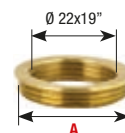

### Art. 00080

Coprifiletto deviatore cromato  
Diverter cover thread  
Verchromte Gewindeabdeckung  
für das Umstellventil

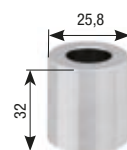

### Art. PR22/19

Protezione coprifiletto  
Thread protection  
Gewindeabdeckungsschutz

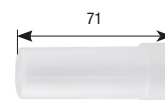

### Art. 190

Innesto rapido  
Fast connection  
Schnellkupplung



### Art. 5700 TAP

Tappo di chiusura  
Closing plug  
Verschlussstopfen



### Art. 5700 PTG

Portagomma  
Endhoser  
Schlauchverbindung

