

Art. 2190Q

versione quadrata
square version
Quadratische Ausführung

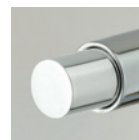

Art. 2190MN

versione minimal
minimal design version
Minimalistische Ausführung
ottone cromato o ABS
brass-chrome or ABS
Verchromtes Messing oder ABS

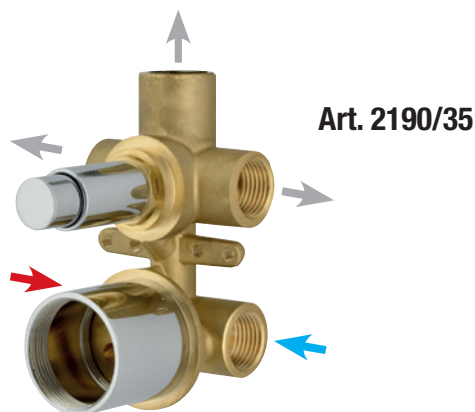
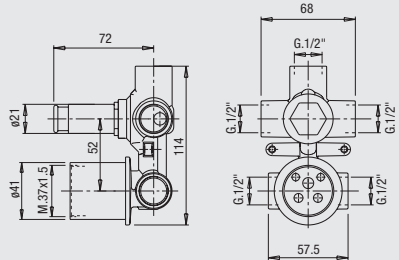

Art. 2190/35Q

versione quadrata
square version
Quadratische Ausführung

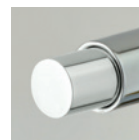

Art. 2190/35MN

versione minimal
minimal design version
Minimalistische Ausführung
ottone cromato o ABS
brass-chrome or ABS
Verchromtes Messing oder ABS

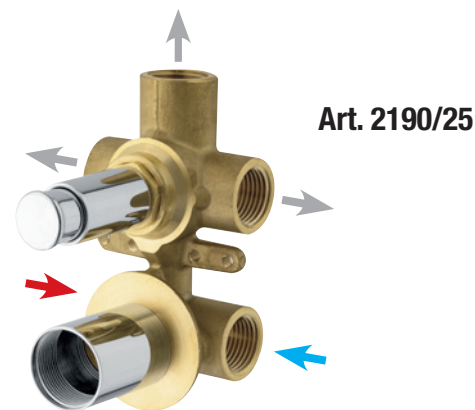
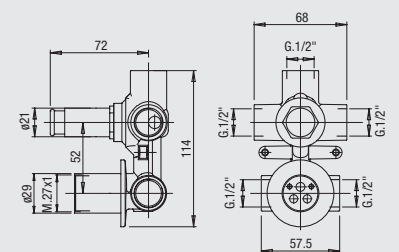

Art. 2190/25Q

versione quadrata
square version
Quadratische Ausführung



Art. 2190/25MN

versione minimal
minimal design version
Minimalistische Ausführung
ottone cromato o ABS
brass-chrome or ABS
Verchromtes Messing oder ABS

Diagramma di portata (uscita libera)
Flow diagram (free exit)

Diagramm der Durchflussleistung (freier Ausgang)

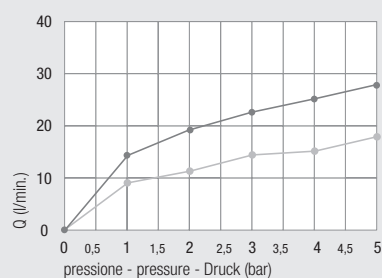

— Ø 40 - Ø 35
— Ø 25

Pistre idonee - *Appropriate plates* - Passende Platten (pag. 82-83)

Art. 2190/35 Art. 1182... - 1192... - 1192/P... - 1030CA - 1186... - 1182/P...







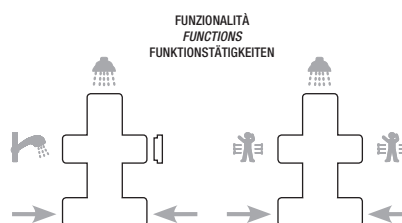



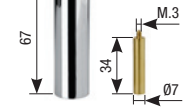







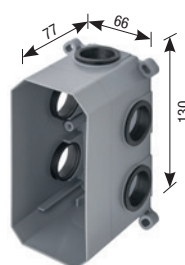

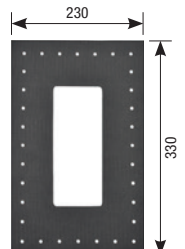

Art. 2190 Art. 1183... - 1193/P... - 1193... - 1187... - 1040CA - 1183/P...

Art. 2190/25 Art. 1192/P25CA - 1325CA

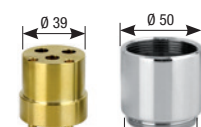
- Disponibile in DZR
- Available in DZR brass
- Erhältlich in DZR

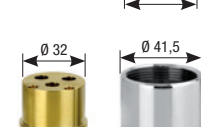

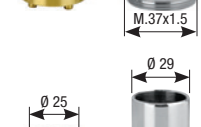
Accessori - *Accessories* - Zubehörteile

- | | | | |
|-----------------------------------------------------------------------------------------------------------------------------------------------|-------------------------------------------------------------------------------------|--------------------------------------------------------------------------------------------------------------------------------------------------|------------------------------------------------------------------------------------------------------------------------------------------------------------------------------------------------------|
| <p>Art. 1161
Anello sede cartuccia
<i>Cartridge ring seat</i>
Kartuschenringsitz</p> |  | <p>Art. 610
Prolunga deviatore
<i>Diverter extension</i>
Verlängerung Umstellventil</p> |  |
| <p>Art. 1013/35
Anello sede cartuccia
<i>Cartridge ring seat</i>
Kartuschenringsitz</p> |  | <p>Art. PR50
Protezione mix
<i>Mix protection</i>
Schutzvorrichtung Mixer</p> | <p>Art. PR20
Protezione in plastica
<i>Plastic protection</i>
Kunststoffschutzvorrichtung</p>  |
| <p>Art. 1013/25
Anello sede cartuccia
<i>Cartridge ring seat</i>
Kartuschenringsitz</p> |  | <p>Art. PR42
Protezione mix
<i>Mix protection</i>
Schutzvorrichtung Mixer</p> | <p>Art. PR29
Protezione mix
<i>Mix protection</i>
Schutzvorrichtung Mixer</p>  |
| <p>Art. 1500
Cappuccio ABS
<i>ABS cap</i>
ABS-Kappe</p> |  | <p>Art. 2180PRPOL
Protezione in polistirolo
<i>Polystyrene protection</i>
Polystyrolschutzvorrichtung</p> |  |
| <p>Art. 1003SF
Cappuccio ABS
<i>ABS cap</i>
ABS-Kappe</p> |  | <p>Art. 3182CG
Scatola di assemblaggio System box
<i>Multipurpose assembling box System box</i>
Montagegehäuse System box</p> |  |
| <p>Art. 1003/25
Cappuccio ABS
<i>ABS cap</i>
ABS-Kappe</p> |  | <p>Art. 3183
Coperchio scatola
<i>Box cover</i>
Gehäuseabdeckung</p> |  |
| <p>Art. 1501
Ghiera serraggio
<i>Ring nut</i>
Gewindeverschraubung</p> |  | <p>Art. 3181ME
Membrana isolante
<i>Insulating membrane</i>
Isolierungsmembran</p> |  |
| <p>Art. 1004BS
Ghiera
<i>Ring nut</i>
Gewindehülse</p> |  | <p>Art. 3185
Prolunga G. 1/2"
<i>Extension G. 1/2"</i>
Verlängerung mit 1/2"-Drehung</p> |  |
| <p>Art. 1004/25
Ghiera
<i>Ring nut</i>
Gewindehülse</p> |  | <p>Art. 3181G1/2
Guarnizione G. 1/2"
<i>Gasket G. 1/2"</i>
Dichtung mit 1/2"-Drehung</p> |  |
| <p>Art. 600
Kit prolunga sede cartuccia
<i>Extension kit for cartridge seat</i>
Verlängerungsbausatz Kartuschensitz</p> |  | <p>Art. 3185
Prolunga G. 1/2"
<i>Extension G. 1/2"</i>
Verlängerung mit 1/2"-Drehung</p> |  |
| <p>Art. 600/35
Kit prolunga sede cartuccia
<i>Extension kit for cartridge seat</i>
Verlängerungsbausatz Kartuschensitz</p> |  | <p>Art. 3185
Prolunga G. 1/2"
<i>Extension G. 1/2"</i>
Verlängerung mit 1/2"-Drehung</p> |  |
| <p>Art. 600/25
Kit prolunga sede cartuccia
<i>Extension kit for cartridge seat</i>
Verlängerungsbausatz Kartuschensitz</p> |  | <p>Art. 3185
Prolunga G. 1/2"
<i>Extension G. 1/2"</i>
Verlängerung mit 1/2"-Drehung</p> |  |