

Deviatore ceramico

Ceramic diverter

Keramik-Umstellventil

DZR Available

UPC IAPMO

ACS

WRAS

KTW

Diagramma di portata (uscita libera)

Flow diagram (free exit)

Diagramm der Durchflussleistung (freier Ausgang)

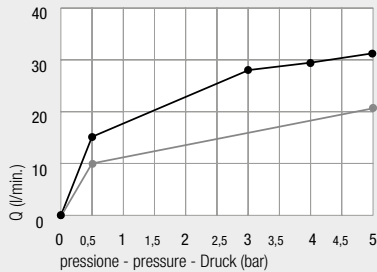

● uscita vasca - *bath exit* - Ausgang Badewanne
 ● uscita doccia - *shower exit* - Ausgang Dusche

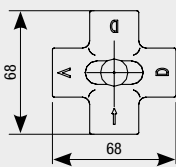
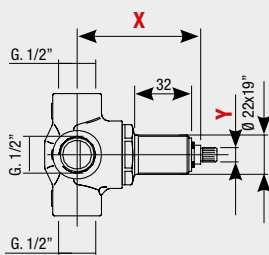

X **Y**

72	BR. Ø 7,65 x Z=20 BR. Ø 8 x Z=24
83,5	BR. Ø 7,65 x Z=20 BR. Ø 8 x Z=24
92	BR. Ø 7,65 x Z=20 BR. Ø 8 x Z=24
112,5	BR. Ø 7,65 x Z=20 BR. Ø 8 x Z=24

3 exits

1 entrata, 3 uscite, con OFF
 1 entrée, 3 exits and OFF position
 1 Eingang, 3 Ausgänge mit OFF



NPT
Available

Art. 2209

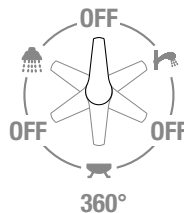

Art. 2209CA

CON alette di fissaggio
 WITH fixing system
 MIT Befestigungsrippen



Art. 00120
 Maniglia deviatore
 Diverter handle
 Umstellgriff

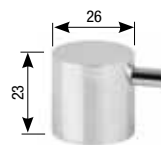

Adattatore
 Ring adaptor
 Adapter
 Art. 2501 A Ø 26X19"
 Art. 2502 A Ø 27X19"
 Art. 2504 A G.3/4"



Art. 00080
 Coprifiletto deviatore cromato
 Diverter cover thread
 Verchromte Gewindeabdeckung
 für das Umstellventil



Art. PR22/19
 Protezione coprifiletto
 Thread protection
 Gewindeabdeckungsschutz

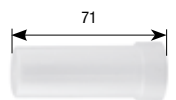

Art. 3188
 Scatola di assemblaggio
 Multipurpose assembling box
 Montagegehäuse

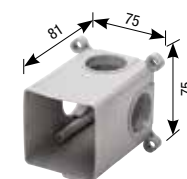

Art. 3189
 Coperchio scatola
 Box cover
 Gehäuseabdeckung

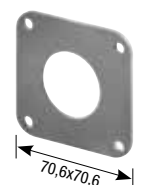

Art. 3188ME
 Membrana isolante
 Insulating membrane
 Isolierungsmembran

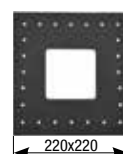

Art. 3181G1/2
 Guarnizione G.1/2"
 Gasket G.1/2"
 Dichtung mit 1/2"-Drehung

