

Miscelatore doccia incasso

Concealed shower mixer

Einbau-Mischbatterie für Duschen

Ø35 2 exits



con deviatore **ceramico**
with **ceramic diverter**
Keramik-Umstellventil

DZR
Available

Diagramma di portata
(uscita libera)

Flow diagram
(free exit)

Diagramm der
Durchflussleistung
(freier Ausgang)

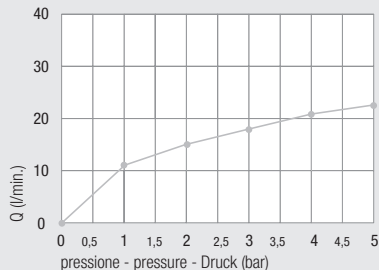

Piastre idonee - *Appropriate plates* - Passende Platten pag. 88



Art. 1182...



Art. 1192...



Art. 1192/P...



Art. 1030CA



Art. 1186...

kit prolunga sede cartuccia

Extension kit for cartridge seat

Verlängerungsbausatz Kartuschensitz

Art. 600/35

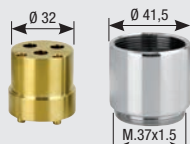

Art. 600/35 SC

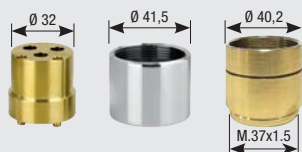

Art. 2180/35CER 2

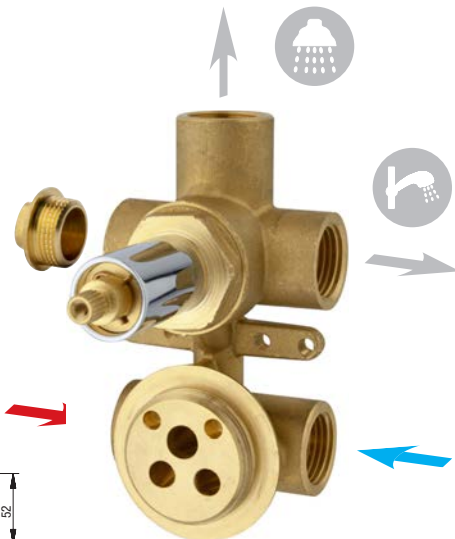
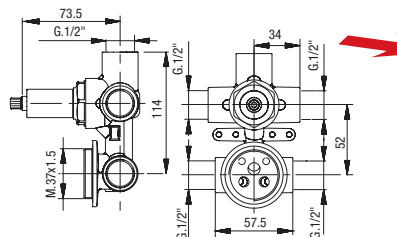

Art. 2190/35CER 2

Con bicchiere

With cartridge ring seat

Mit Kartuschenringsitz

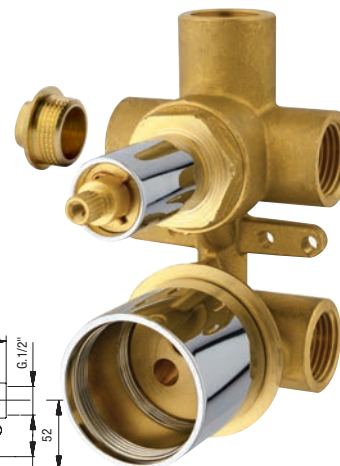
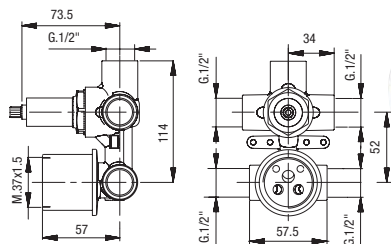

Art. 2190/35CER 2 SC



Con cappuccio scorrevole

With sliding sleeve

Mit Schiebehaube

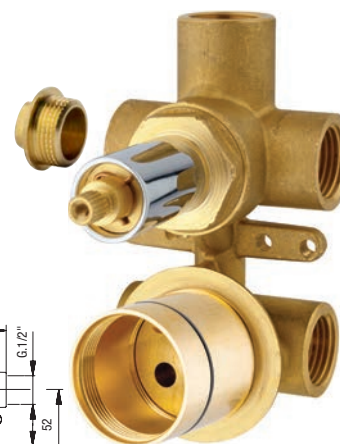
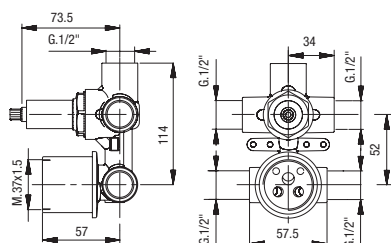

Versione prolungata
Extended version
Erweiterte Version

Art. 2180/35CER 2 AL

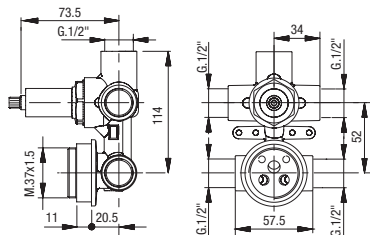

Art. 2190/35CER 2 AL

Con bicchiere
With cartridge ring seat
Mit Kartuschenringsitz

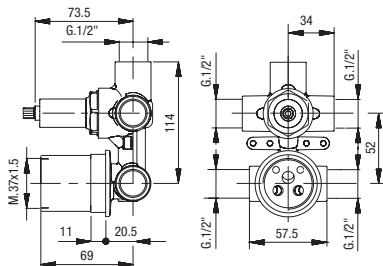

Art. 2190/35CER 2 AL SC



Con cappuccio scorrevole
With sliding sleeve
Mit Schiebehaube

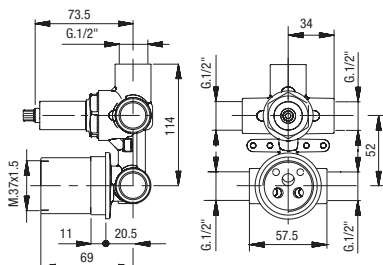

Art. 1013/35
Anello sede cartuccia
Cartridge ring seat
Kartuschenringsitz



Art. 1003SF
Cappuccio ABS
ABS cap
ABS-Kappe



Art. 1004BS
Ghiera
Ring nut
Gewindehülse



Art. 630
Prolunga deviatore
Diverter extension
Verlängerung Umstellventil

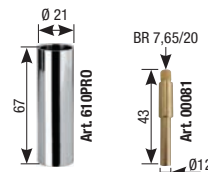

Art. 00122
Maniglia deviatore
Diverter handle
Umstellgriff

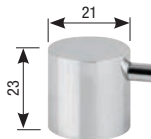

Art. 1502PRO
Coprifiletto deviatore cromato
Diverter cover thread
Verchromte Gewindeabdeckung Umstellventil

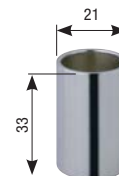

Art. 1468
Anello sede cartuccia
Cartridge ring seat
Kartuschenringsitz



Art. 1465
Cappuccio scorrevole
Sliding sleeve
Schiebehaube



Art. PR42
Protezione mix
Mix protection
Schutzvorrichtung Mixer



Art. PR20
Protezione in plastica
Plastic protection
Kunststoffschutzvorrichtung



Art. 3182CG (pag. 101)
Scatola di assemblaggio
Multipurpose assembly box
Montagegehäuse

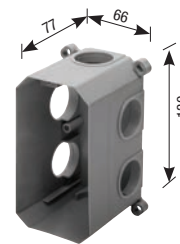

Art. 3183
Coperchio scatola
Box cover
Gehäuseabdeckung



Art. 3181ME
Membrana isolante
Insulating membrane
Isolierungsmembran

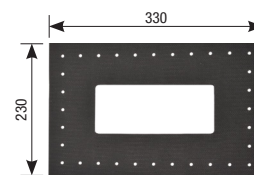

Art. 3185
Prolunga G. 1/2"
Extension G. 1/2"
Verlängerung mit 1/2"-Drehung



Art. 3181G1/2
Guarnizione G. 1/2"
Gasket G. 1/2"
Dichtung mit 1/2"-Drehung

