

# Miscelatore doccia incasso

## Concealed shower mixer

### Einbau-Mischbatterie für Duschen

Ø35 3 exits



con deviatore **ceramico**  
with **ceramic diverter**  
**Keramik-Umstellventil**

**DZR**  
Available

Diagramma di portata  
(uscita libera)  
*Flow diagram  
(free exit)*  
Diagramm der  
Durchflussleistung  
(freier Ausgang)

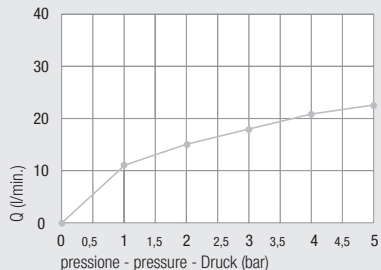

Piastre idonee - *Appropriate plates* - Passende Platten pag. 88



Art. 1182...



Art. 1192...



Art. 1192/P...



Art. 1030CA



Art. 1186...

kit prolunga sede cartuccia  
*Extension kit for cartridge seat*  
Verlängerungsbausatz Kartuschensitz

Art. 600/35

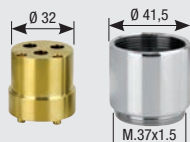

Art. 600/35 SC



Art. 2180/35CER

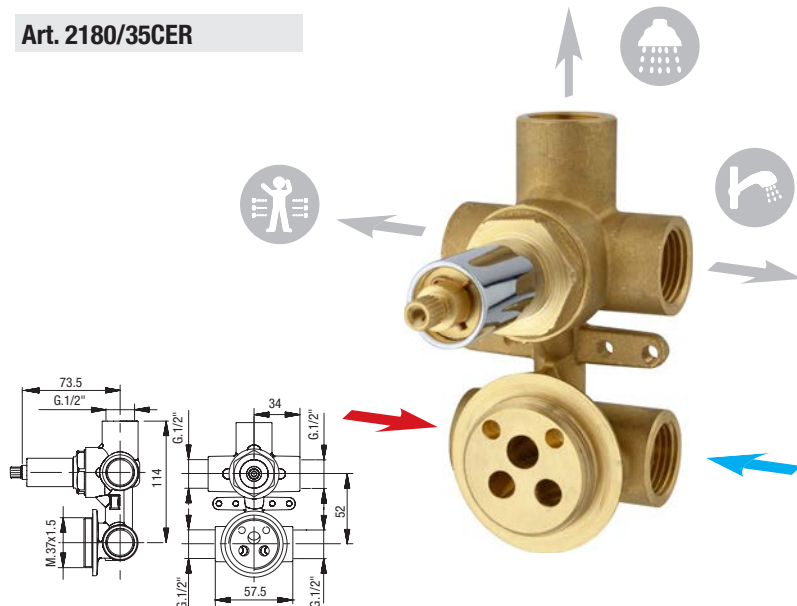

Art. 2190/35CER

Con bicchiere  
*With cartridge ring seat*  
Mit Kartuschenringsitz

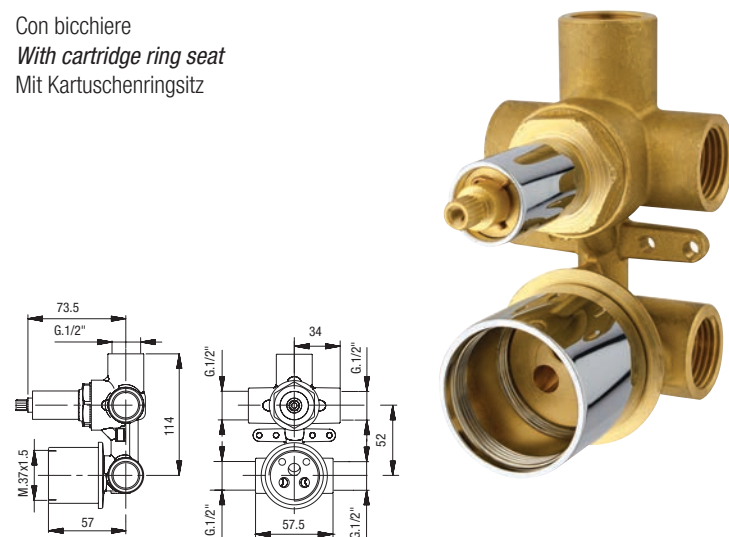

Art. 2190/35CER SC



Con cappuccio scorrevole  
*With sliding sleeve*  
Mit Schiebehaube

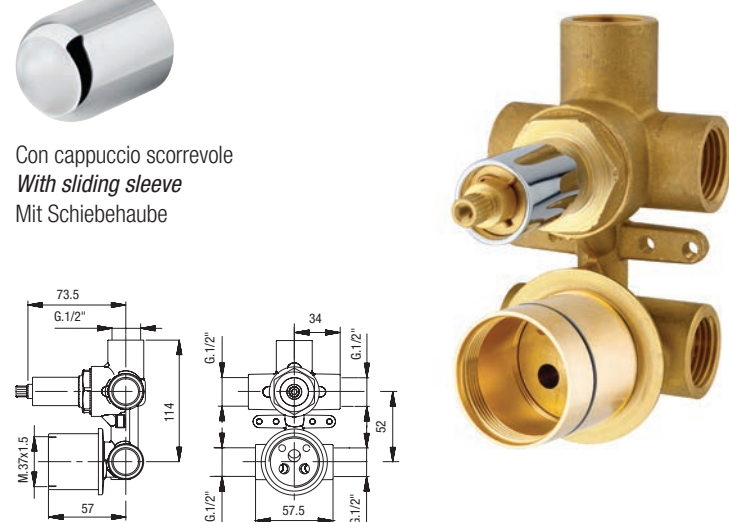

**Versione prolungata**  
**Extended version**  
**Erweiterte Version**

**Art. 2180/35CER AL**

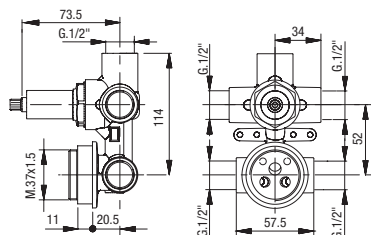

**Art. 2190/35CER AL**

Con bicchiere  
*With cartridge ring seat*  
Mit Kartuschenringsitz

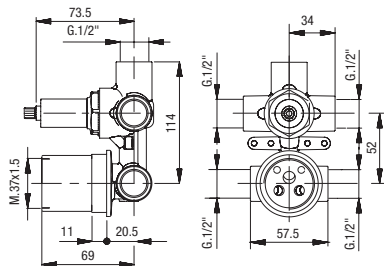

**Art. 2190/35CER AL SC**



Con cappuccio scorrevole  
*With sliding sleeve*  
Mit Schiebehaube

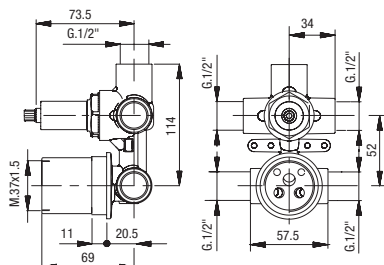

**Art. 1013/35**  
Anello sede cartuccia  
*Cartridge ring seat*  
Kartuschenringsitz



**Art. 1003SF**  
Cappuccio ABS  
*ABS cap*  
ABS-Kappe

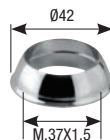

**Art. 1004BS**  
Ghiera  
*Ring nut*  
Gewindehülse



**Art. 630**  
Prolunga deviatore  
*Diverter extension*  
Verlängerung Umstellventil

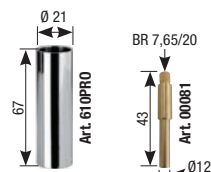

**Art. 00122**  
Maniglia deviatore  
*Diverter handle*  
Umstellgriff

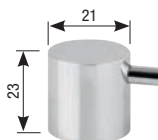

**Art. 1502PRO**  
Coprifiletto deviatore cromato  
*Diverter cover thread*  
Verchromte Gewindeabdeckung Umstellventil

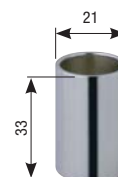

**Art. 1468**  
Anello sede cartuccia  
*Cartridge ring seat*  
Kartuschenringsitz



**Art. 1465**  
Cappuccio scorrevole  
*Sliding sleeve*  
Schiebehaube



**Art. PR42**  
Protezione mix  
*Mix protection*  
Schutzvorrichtung Mixer



**Art. PR20**  
Protezione in plastica  
*Plastic protection*  
Kunststoffschutzvorrichtung



**Art. 3182CG (pag. 101)**  
Scatola di assemblaggio  
*Multipurpose assembly box*  
Montagegehäuse

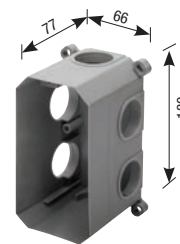

**Art. 3183**  
Coperchio scatola  
*Box cover*  
Gehäuseabdeckung



**Art. 3181ME**  
Membrana isolante  
*Insulating membrane*  
Isolierungsmembran

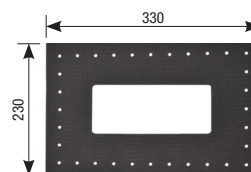

**Art. 3185**  
Prolunga G. 1/2\"/>  
*Extension G. 1/2\"*  
Verlängerung mit 1/2\"-Drehung



**Art. 3181G1/2**  
Guarnizione G. 1/2\"/>  
*Gasket G. 1/2\"*  
Dichtung mit 1/2\"-Drehung

