

Deviatore ceramico

Ceramic diverter

Keramik-Umstellventil

DZR
Available

UPC
IAPMO

ACS

WRAS

KTW

Diagramma di portata
(uscita libera)

Flow diagram
(free exit)

Diagramm der
Durchflussleistung
(freier Ausgang)

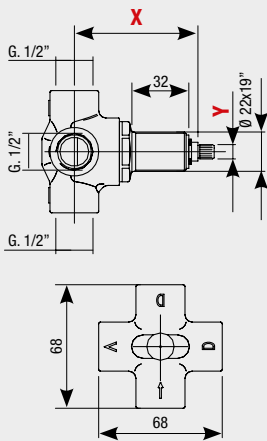
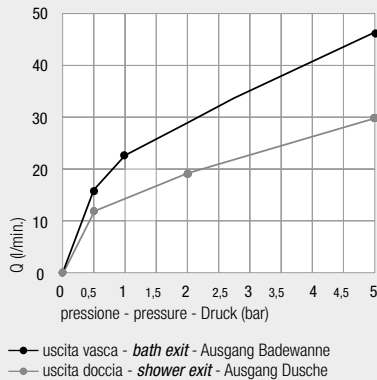

X	Y
72	BR. Ø 7,65 x Z=20 BR. Ø 8 x Z=24
83,5	BR. Ø 7,65 x Z=20 BR. Ø 8 x Z=24
92	BR. Ø 7,65 x Z=20 BR. Ø 8 x Z=24
112,5	BR. Ø 7,65 x Z=20 BR. Ø 8 x Z=24

3
exits

1 entrata, 3 uscite
1 entrée, 3 exits
1 Eingang, 3 Ausgänge

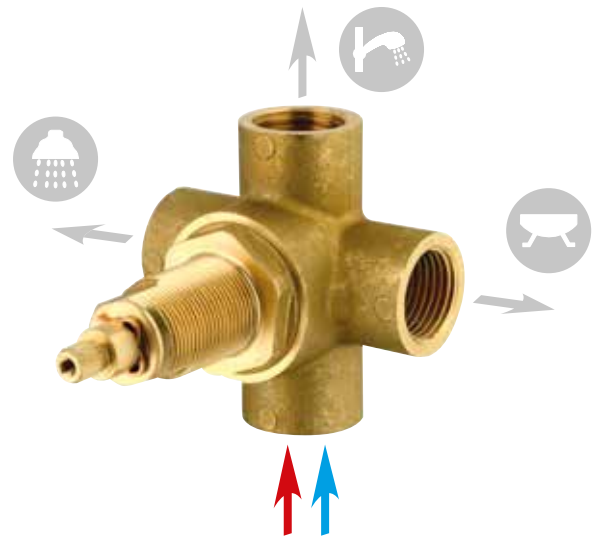

Art. 2203

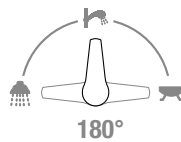

Art. 2203CA

CON alette di fissaggio
WITH fixing system
MIT Befestigungsrippen

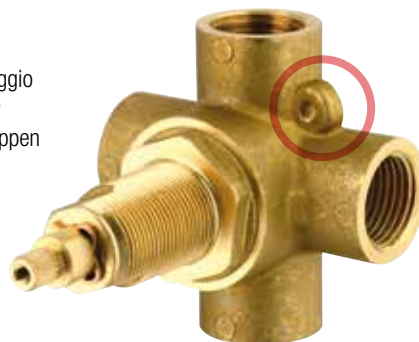

Art. 00120
Maniglia deviatore
Diverter handle
Umstellgriffn

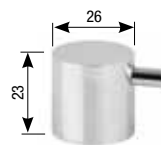

Adattatore
Ring adaptor
Adapter
Art. 2501 A Ø 26X19"
Art. 2502 A Ø 27X19"
Art. 2504 A G.3/4"



Art. 00080
Coprifiletto deviatore cromato
Diverter cover thread
Verchromte Gewindeabdeckung
für das Umstellventil

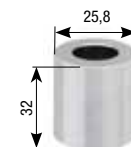

Art. PR22/19
Protezione coprifiletto
Thread protection
Gewindeabdeckungsschutz

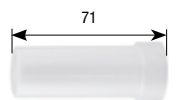

Art. 3188
Scatola di assemblaggio
Multipurpose assembling box
Montagegehäuse

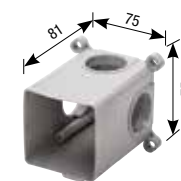

Art. 3189
Coperchio scatola
Box cover
Gehäuseabdeckung

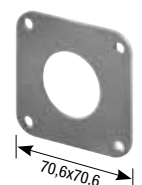

Art. 3188ME
Membrana isolante
Insulating membrane
Isolierungsmembran

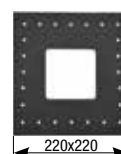

Art. 3181G1/2
Guarnizione G.1/2"
Gasket G.1/2"
Dichtung mit 1/2"-Drehung

