

Deviatore ceramico

Ceramic diverter

Keramik-Umstellventil



Diagramma di portata
(uscita libera)

Flow diagram
(free exit)

Diagramm der
Durchflussleistung
(freier Ausgang)

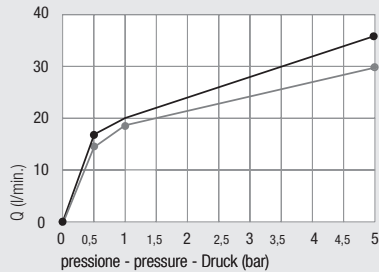

— uscita vasca - *bath exit* - Ausgang Badewanne
— uscita doccia - *shower exit* - Ausgang Dusche

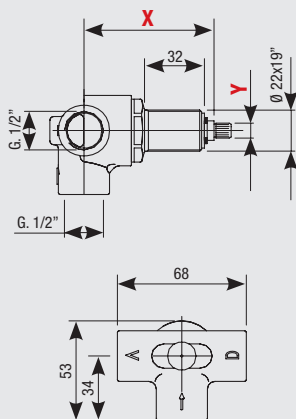

X	Y
72	BR. Ø 7,65 x Z=20 BR. Ø 8 x Z=24
83,5	BR. Ø 7,65 x Z=20 BR. Ø 8 x Z=24
92	BR. Ø 7,65 x Z=20 BR. Ø 8 x Z=24
112,5	BR. Ø 7,65 x Z=20 BR. Ø 8 x Z=24



1 entrata, 2 uscite con OFF
1 entrée, 2 exits with OFF position
1 Eingang, 2 Ausgänge mit OFF

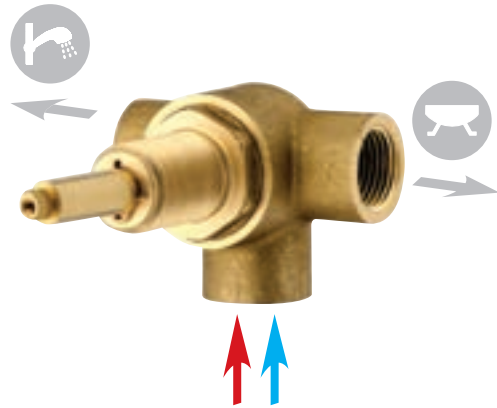

NPT
Available

Art. 2205

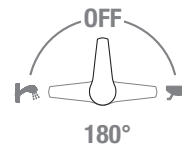

180°

Art. 2205 SF

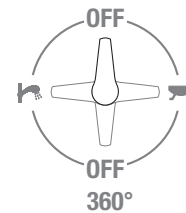

360°

Art. 2205/90



90°

Art. 2205CA

Art. 2205CA SF

Art. 2205CA/90

CON alette di fissaggio
WITH fixing system
MIT Befestigungsrippen



Art. 00120
Maniglia deviatore
Diverter handle
Umstellgriffn



Adattatore
Ring adaptor
Adapter
Art. 2501 A Ø 26X19"
Art. 2502 A Ø 27X19"
Art. 2504 A G.3/4"



Art. 00080
Coprifiletto deviatore cromato
Diverter cover thread
Verchromte Gewindeabdeckung
für das Umstellventil

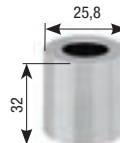

Art. PR22/19
Protezione coprifiletto
Thread protection
Gewindeabdeckungsschutz



Art. 3188
Scatola di assemblaggio
Multipurpose assembling box
Montagegehäuse

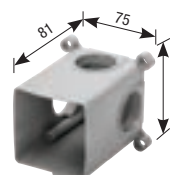

Art. 3189
Coperchio scatola
Box cover
Gehäuseabdeckung

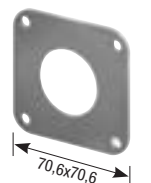

Art. 3188ME
Membrana isolante
Insulating membrane
Isolierungsmembran

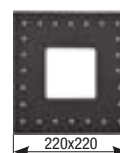

Art. 3181G1/2
Guarnizione G.1/2"
Gasket G.1/2"
Dichtung mit
1/2"-Drehung



Art. 00097GU3
Tappo ø 33 mm
Plug ø 33 mm
Stopfen ø 33 mm

