

MIX DOCCIA INCASSO A 2/3 USCITE Ø 40 - DEVIATORE CERAMICO

CONCEALED SHOWER MIXER 2/3 EXITS Ø 40 - CERAMIC DIVERTER

EINBAU-MISCHBATTERIE FÜR DUSCHEN MIT 2/3 AUSGÄNGEN Ø 40 – KERAMIK-UMSTELLVENTIL

Art. 2180CER



Art. 2190CER



- Possibilità di produzione in DZR
- Possible to be produced in DZR brass
- Möglichkeit für eine Produktion in DZR

FUNZIONALITÀ
FUNCTIONS
FUNKTIONSTÄTIGKEITEN



Diagramma di portata (uscita libera)
Flow diagram (free exit)
Diagramm der Durchflussleistung (freier Ausgang)

USCITA DOCCIA
SHOWER EXIT
AUSGANG DUSCHE

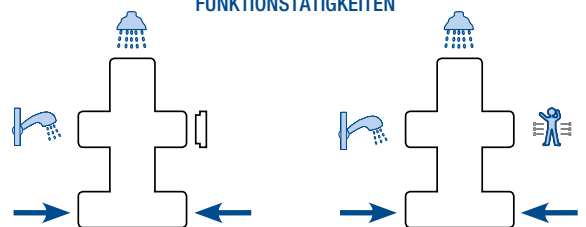
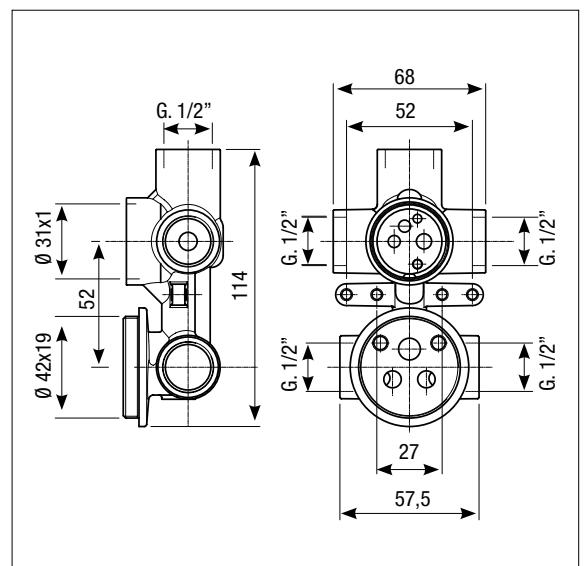
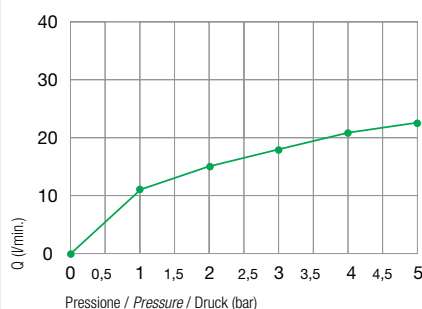

Piastre idonee (vedi pag. 93)
Appropriate plates (page 93)
 Passende Platten (pag. 93)

Art. 1183 - 1193/P - 1193 - 1187 - 1040CA - 1183/P

ACCESSORI / ACCESSORIES / ZUBEHÖRTEILE

Art. 1161

Anello sede cartuccia
Cartridge ring seat
 Kartuschenringsitz



Art. 1500

Cappuccio ABS
ABS cap
 ABS-Kappe



Art. 1005

Viti di fissaggio
Fastening screws
 Befestigungsschrauben
 M.5 L=45



Art. 1501

Ghiera
Ring nut
 Gewindehülse
 45x19



Art. 630

Prolunga deviatore
Diverter extension
 Verlängerung Umstellventil

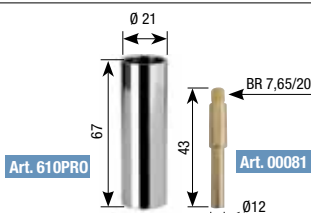

Art. 00122

Maniglia deviatore
Diverter handle
 Umstellgriff

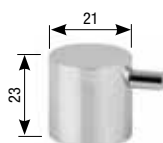

Art. 1502PRO

Coprifiletto deviatore cromato
Diverter cover thread
 Verchromte Gewindeabdeckung
 Umstellventil

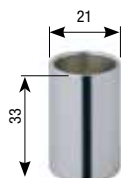

Art. 2180PROPOL

Protezione in polistirolo
Polystyrene protection
 Polystyrolschutzvorrichtung



Art. 00097

Scatola di assemblaggio
System box
 Multipurpose assembling box
 System box
 Montagegehäuse
 System box

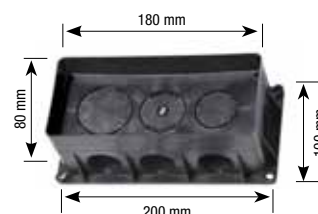

Art. 00097ME

Membrana isolante
 330x230 mm
Insulating membrane
 330x230 mm
 Isoliermembran
 330x230 mm



Art. 00097GU1

Anello gomma foro 25,2 mm (3/4")
O-ring 3/4"
 Gummiring mit einer Bohrung
 von 25,2 mm (3/4")



Art. 00097GU2

Anello gomma foro 19 mm (1/2")
O-ring 1/2"
 Gummiring mit einer Bohrung
 von 19 mm (1/2")



Art. 00097GU3

Tappo Ø 33 mm
Plug Ø 33 mm
 Stopfen Ø 33 mm

